

## Be Connect Plus (BCP)

### Short Guide V1.4 (03.12.2020)

#### Note:

With Be Connect Plus (BCP) you can read the battery information, configure the battery system and update the battery firmware. You need a windows computer that will be connected to the battery Wifi.

BCP is constantly being improved and updated. The latest version can always be found on the website of BYD Battery-Box or the local service partner. Make sure to use the latest program version.

### 1) Open & Connect

- 1.1) Connect to the battery WiFi (Wifi Password: BYDB-Box).
- 1.2) Unzip the package file, and double click the "BeConnectPlus.exe".

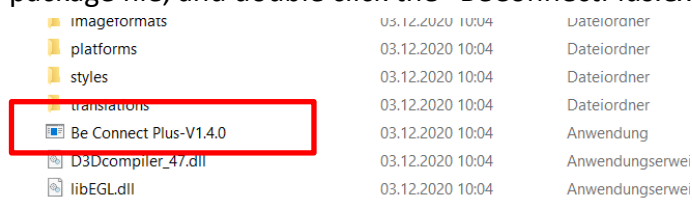

- 1.3) Click "Connect" at the left corner of the interface to connect to battery. Then click on "Refresh".

*Note: If it shows "connection failed", please make sure that you are connected to the battery wifi. Then try again.*

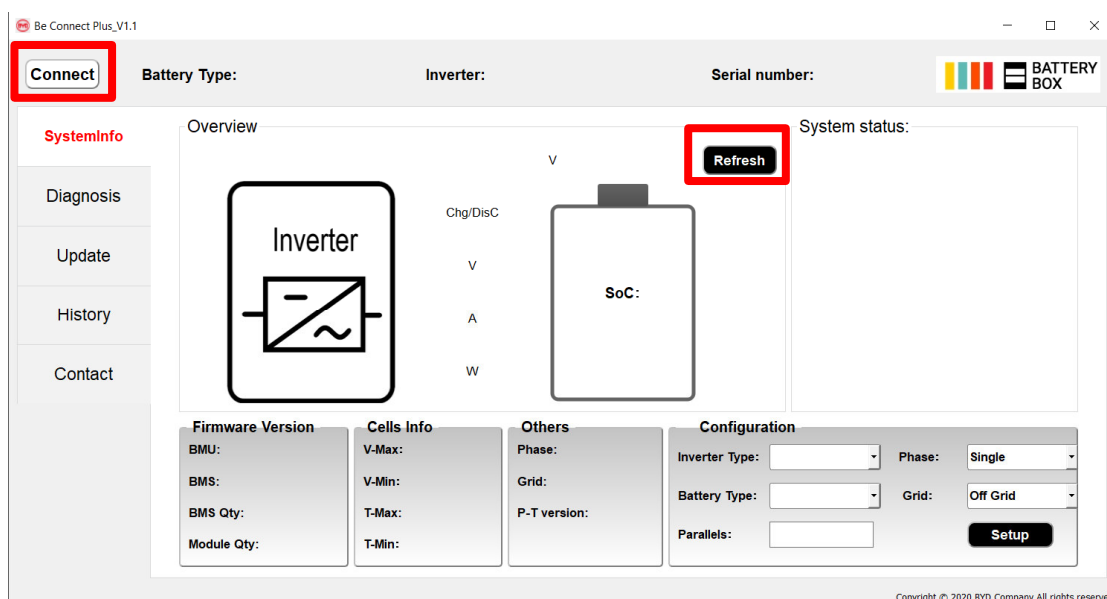

## 2) Configuration

- 2.1) In the section “SystemInfo” you can do the configuration (Inverter type, Phase, Module Quantity, Grid), then click on “Setup” to save it. The configuration is done.

*Note: To refresh, close tool and then reopen it again. Then you can check if the settings have been saved correctly.*

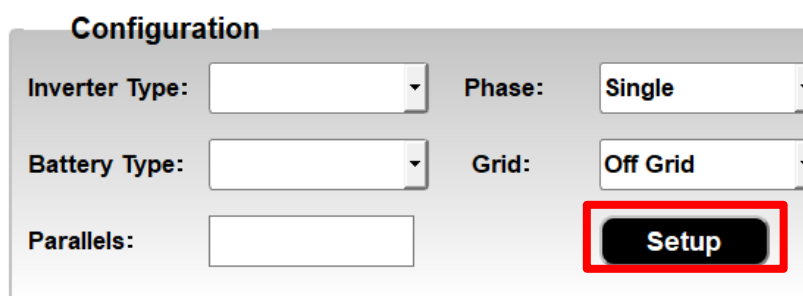

The Configuration dialog box contains the following fields:

- Inverter Type:** A dropdown menu.
- Phase:** A dropdown menu with "Single" selected.
- Battery Type:** A dropdown menu.
- Grid:** A dropdown menu with "Off Grid" selected.
- Parallels:** A text input field.
- Setup:** A button highlighted with a red rectangle.

## 3) Update

- 3.1) Click on “Download” to download the latest FW. BCP will then check if there are newer versions on the server and download it then locally on your laptop.

*Note: Internet connection necessary for this step.*

- 3.2) BMU Update: Select “BMU” and then on “F/W Update”.

- 3.3) BMS Update: Select “BMS” and then on “F/W Update”.

*Note: The installation of the BMS FW takes approx 20min after. So when it has reached 100%, please wait 20 minutes. Close and reopen the program and then check if FW has been correctly updated.*

- 3.4) Parameter-Table Update: Click on “P/T Update”

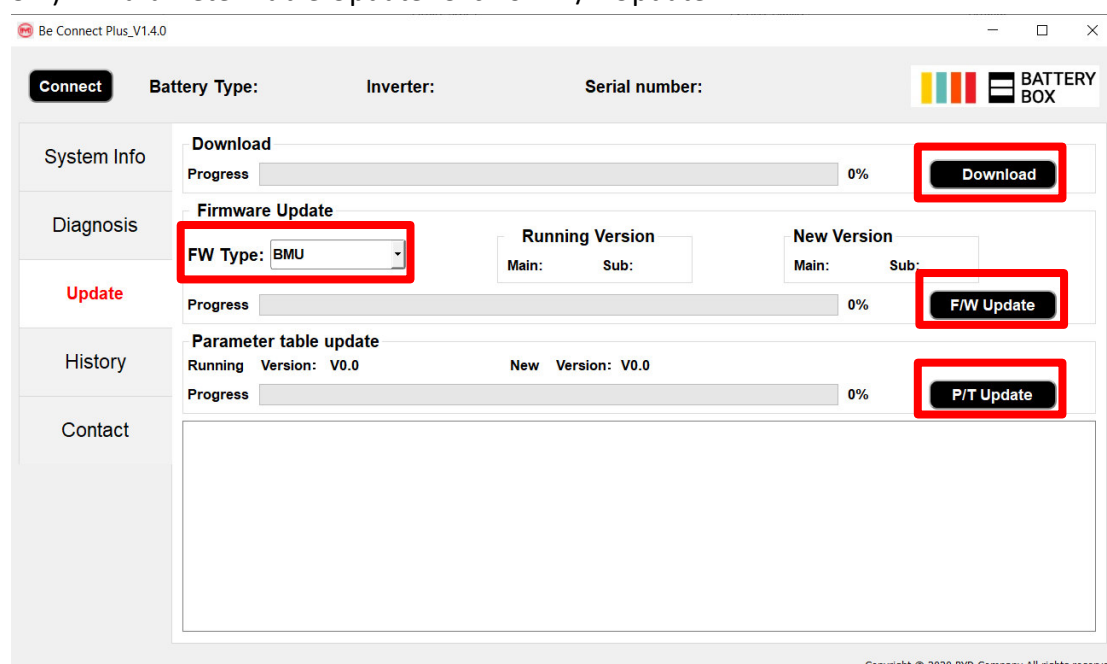

The main interface of Be Connect Plus V1.4.0 shows the following sections:

- Connect:** A button at the top left.
- Battery Type:** A dropdown menu.
- Inverter:** A dropdown menu.
- Serial number:** A text input field.
- BATTERY BOX:** A status indicator with a battery icon.
- System Info:** A section containing a "Download" button highlighted with a red rectangle.
- Diagnosis:** A section containing a "Firmware Update" section with a "FW Type" dropdown menu (set to "BMU") highlighted with a red rectangle, and a "F/W Update" button highlighted with a red rectangle.
- Update:** A section containing a "Parameter table update" section with a "P/T Update" button highlighted with a red rectangle.
- History:** A section with a progress bar for the parameter table update.
- Contact:** A section with a large empty text area.

## 4) Troubleshoot

Note: This section is only required if there is a service problem. In this case, please also refer to the Battery-Box Service Guideline and Checklist

- 4.1) You can check the current status in the tab (e.g alarm events) in the section "Diagnosis". Click on "read" and wait a couple of seconds for the data to be displayed.

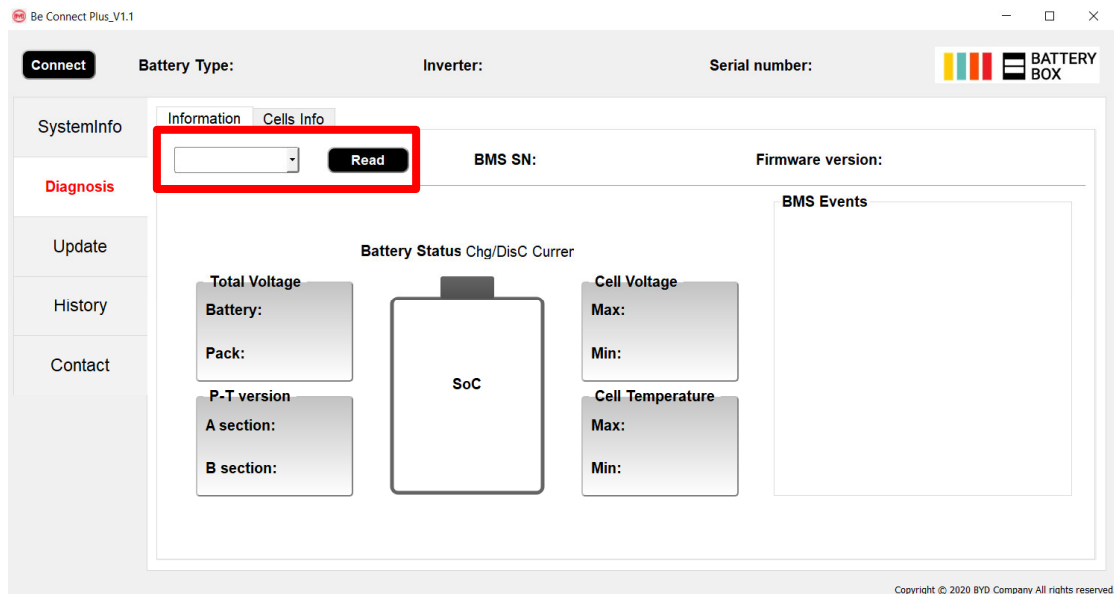

- 4.2) Cell-Log: In the section "diagnosis" select the tab "Cell Info" and export the cell data to an excel file ("Export to Excel")
- 4.3) BMU-Log: In the section "History" select "BMU". Enter the requested quantity of data points in "Historcal Data Quantity" (recommendation: 300). Then click on "Read Historical Data" and wait until all the data has been imported. Then please export it to an excel (→"Export to Excel")
- 4.4) BMS-Log: In the section "History" select "BMS". Enter the requested quantity of data points in "Historcal Data Quantity" (recommendation: 300). Then click on "Read Historical Data" and wait until all the data has been imported. Then please export it to an excel (→"Export to Excel")
- Note: If there are multiple BMS (e.g parallel connected LVL), please repeat for every BMS.
- 4.5) Create a screenshot of the sections "SystemInfo" and "Diagnosis" and of the Events-tab in the section "History"
- 4.6) Send the logs (BMU-History, BMS-History, Cell-Data, Screenshots) to the local service partner together with your ticket number (if already available)

Note: To export the data into an Excel file, you need Microsoft Excel installed on your laptop. If you don't have Excel on your computer please export into a text-file by selecting the file type "TXT" when saving the file. If you still have difficulties exporting the logs, please create screenshots of the relevant sections instead.